

FORM No. 1.

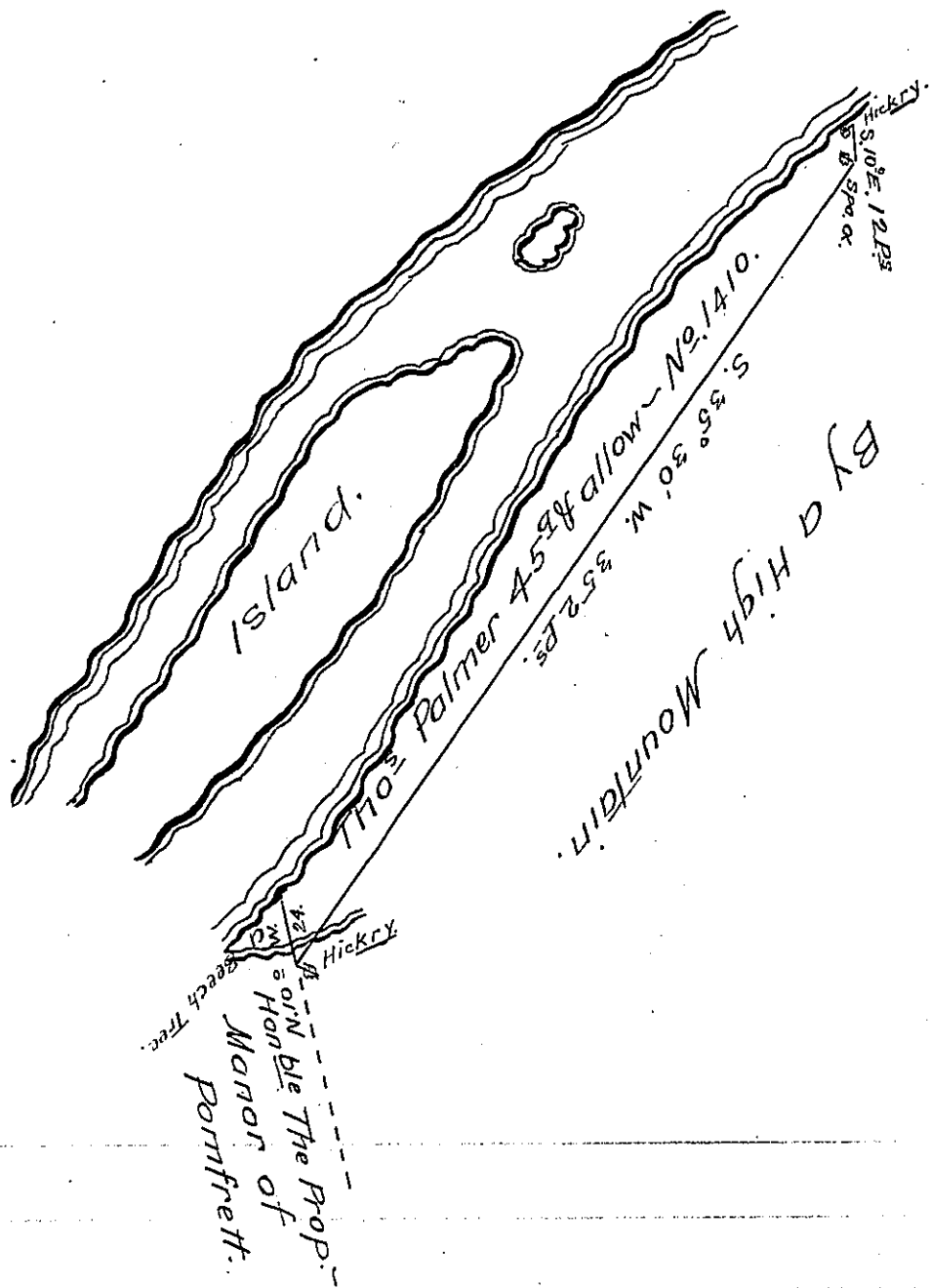

A Draught of a Tract of Land Situate on the South Side of the North East branch of Susquehanna River about a mile and a half from Fort Augusta in the County of Berks Called the Ferry Landing containing forty five Acres and allowance of 6 7/8 Cent. Surveyed the 30th Day of September 1771 for Thomas Palmer In Pursuance of an Application No 1410 Dated the 5^d Day of April 1769.

Chas. Stewart Dep. Sur.

To John Lukens Esq.
Survey^r Gen^l.

IN TESTIMONY that the above is a copy of the original remaining on file in the Department of Internal Affairs of Pennsylvania, made conformably to an Act of Assembly approved the 16th day of February, 1833, I have hereunto set my Hand and caused the Seal of said Department to be affixed at Harrisburg, this Twenty third day of April. 1906.

Joseph B. ...
Secretary of Internal Affairs.